

Redrok.



6 Prowse Walk EPPING VIC

4  2  2 

This well designed four bedroom home is ideal for first home buyers, investors, downsizer and young professionals.

View : <https://www.redrok.com.au/sale/vic/north/epping/residential/house/7234777>

Epitomising modern elegance, with a free-flowing easy-care floorplan that emphasises immaculate open plan design and clever zoning. Relax in an expansive living domain enhanced by ambient natural light and adjoining family/meals.



Yash Ghedia
03 9462 1100

Kitchen comprising premium s/s appliances, gas cooktop, dishwasher, and tiled splashbacks. An ideal for families craving extra living space, with all living zones. sliding doors facilitate a seamless indoor-outdoor flow to beautifully timber decked alfresco, Accommodating 4 bedrooms (BIRs) and 2 bathrooms with the master displays WIR and ensuite.

<https://www.redrok.com.au>

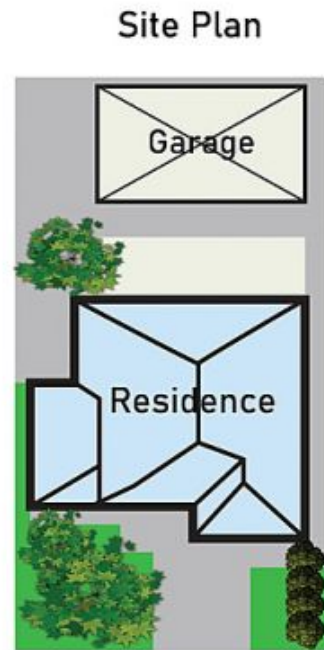
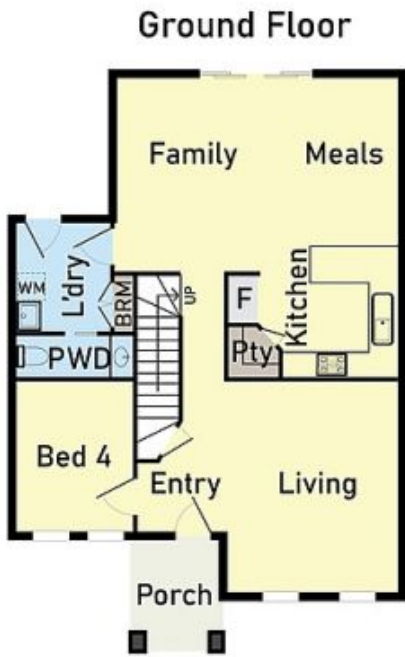

6 Prowse Walk ,Epping

* Dimensions are approximate and for illustrative purposes only